

# DOMUS

LIQUID-FILLED SEALED  
COUNTER TYPE WATER METER

## MODELS

DPRF/13  
DPRF/20  
DPRF/25  
DPRF/30



- \* Single-jet turbine water meter
- \* DPRF model for cold water up to 30 °C
- \* Direct-read roller indicator
- \* The numbered drums are contained in a sealed capsule filled with a special liquid
- \* An anti-fogging system ensures a clear reading in all conditions
- \* The DPRF meter can be used with any kind of water even if particularly hard, scaling, turbid or muddy as the counter will remain protected even in water that contains high level of dirt or other contaminants such as iron
- \* Indelible wet dial
- \* Hydraulic features in line with EEC metrological standards following provision No.75/33

# DOMUS

## LIQUID-FILLED SEALED COUNTER TYPE WATER METER

Nominal size of the meter			13	20	25	30
Qmax	Maximum flow rate	m <sup>3</sup> /h	3	5	7	10
Qn	Nominal continuous flow rate	m <sup>3</sup> /h	1,5	2,5	3,5	5
Qt	Transitional flow rate with $\pm 2\%$ error	l/h	120	200	280	400
Qmin	Minimum flow rate with $\pm 5\%$ error	l/h	30	50	70	100
Qt	Transitional flow rate with $\pm 2\%$ error in class C	l/h	22,5	37,5	52,5	75
Qmin	Minimum flow rate with $\pm 5\%$ error in class C	l/h	15	25	35	50
	Starting flow	l/h	5	8	13	13
	Dial registers from/to	m <sup>3</sup>	0,0001/100.000	0,0001/100.000	0,0001/100.000	0,0001/100.000
	Working pressure	bar	16	16	16	16
	Test pressure	bar	25	25	25	25
	Length 'A' without pipe fittings	mm	110	130	160	160
	Length 'B' with pipe fittings	mm	190	228	260	280
	Maximum diameter 'C'	mm	75	75	100	100
	Height 'D' with open lid	mm	151	151	185	185
	Height 'E' with closed lid	mm	84	84	103	103
	Height of tube 'F'	mm	24	24	34	34
	Weight including pipe fittings	kg	0,890	1,150	1,870	2,120
	Weight without pipe fittings	kg	0,730	0,900	1,400	1,450

MODELS:

FOR COLD WATER UP TO 30 °C

DPRF/13 1/2"

DPRF/20 3/4"

DPRF/25 1"

DPRF/30 1.1/4"

The Complete DPRF range is EEC homologated according to metrological classes B and C of EEC standards

The Company's policy is one of continuous product improvement and the right is reserved to modify the specifications contained herein without notice

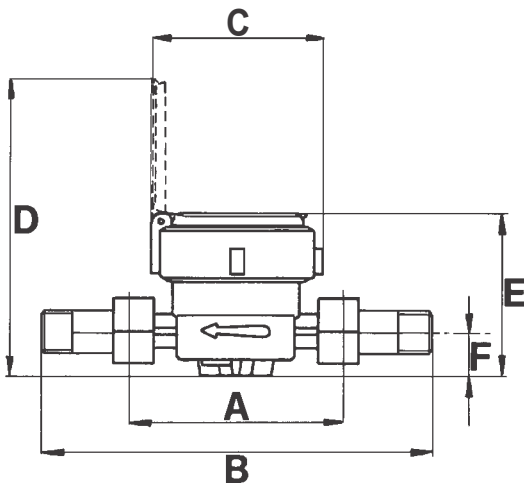

TYPICAL ACCURACY CURVE

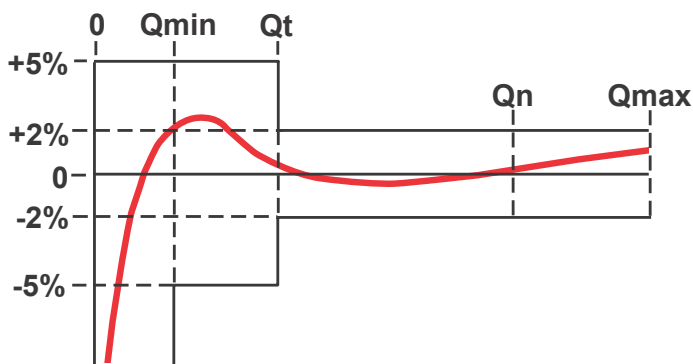

HEAD LOSS DIAGRAM

